

Route 221

Updated: December 2011

Junction with 134 south of Mountain Home to Route 86 at Altamont May 13, 1941.

1953 Description:

From Route 134 south of Mountain Home easterly via Bonita to Route 86 at Altamont.

Approved by the 1963 Legislature:

1964 Description:

From SR-87 in Altamont north to Altonah. ****(*A Scanned)** July 31, 1964

1965 Legislature: (This route formally was SR-87).

1967 Legislature:

1969 Legislature:

Deleted from the State System by the **1969 Legislature.**

* Refers to resolution index page following.

**Refers to Scanned Computer Resolution index on the following page.

Route 221

COUNTY/RESOLUTION VOLUME & NUMBER

A. Duchesne Co. 1/77

DESCRIPTION OF RESOLUTION CHANGE

(A). Deletion - Portion of SR-221 from the Jct. With SR-134 to the Jct. With SR-86.

U-35-7-87-10
U-86-7-87-2205
U-87-0am
U-134-7-87-1-6
U-221-7-87-2105

RESOLUTION

State Routes 35, 86, 87, 134, 221
35 86 87 134 221

WHEREAS, to maintain continuity in the designation of State Routes in the Blue Bench area, north and east of Duchesne City; and

WHEREAS, Representatives of the Utah State Department of Highways, the governing bodies of Altonah, Bluebell, Mountain Home, Duchesne County and the Area Commissioner of the Utah State Road Commission conducted a field trip over all State Routes in the area; and

WHEREAS, there was mutual agreement of all agencies; and

WHEREAS, there will be no increase in State Route mileage,

NOW THEREFORE, be it resolved as follows:

1. That the State Route designation of 87 will commence at the present junction of State Route 6 and 35 in Duchesne City, traversing that portion of State Route 35 to the present junction of State Routes 35 and 134, thus deleting the designation of State Route 35 for this section of roadway, thence northerly traversing the existing portion of State Route 134 to the present junction of State Routes 134 and 221, south of Mountain Home, thus deleting the designation of State Route 134 for this section of roadway, thence continuing easterly traversing existing State Route 221 to its junction with present State Route 86, south of Altonah, thus deleting the State Route designation of 221, thence east, southeasterly and south, traversing existing State Route 86 to its junction with State Route 87, thus deleting the designation of State Route 86 for this section of roadway, thence east via existing State Route 87 to its junction with State Route 6 southwest of Roosevelt.

2. That with the re-designation of State Route 87, the following interim designations be adopted subject to the approval of the legislature:

State Route 35 - From Wanship on Route 2 via Peoa, Kamas and Tabiona to Route 87.

SR- 35,86,87
134 & 221
77

State Route 86 - From Route 6 southeast of Bridgeland, northerly via Bridgeland to Route 87.

State Route 87 - From Route 6 in Duchesne northerly, thence easterly via Altamont, thence southeasterly via Upalco thence east to Route 6 southwest of Roosevelt.

State Route 221 - From Route 87 in Altamont north to Altonah.

State Route 134 - From Route 87, north via Mountain Home to the Uintah and Ouray Indian Reservation Grazing Land Boundary.

State Route 199 - From Route 87, north to Bluebell, thence west to Route 87 east of Altamont.

3. That application be made to the U. S. Department of Commerce, Bureau of Public Roads, to have the Federal-aid Secondary Route designations changed to follow in continuity with the State Route designations.

Dated this 31st day of July, 1964.

STATE ROAD COMMISSION OF UTAH

Ernest Walsh
Chairman

Fred B. [unclear]
Commissioner

Elmer Strong
Commissioner

Ames K. Bagley
Commissioner

Commissioner

ATTEST:

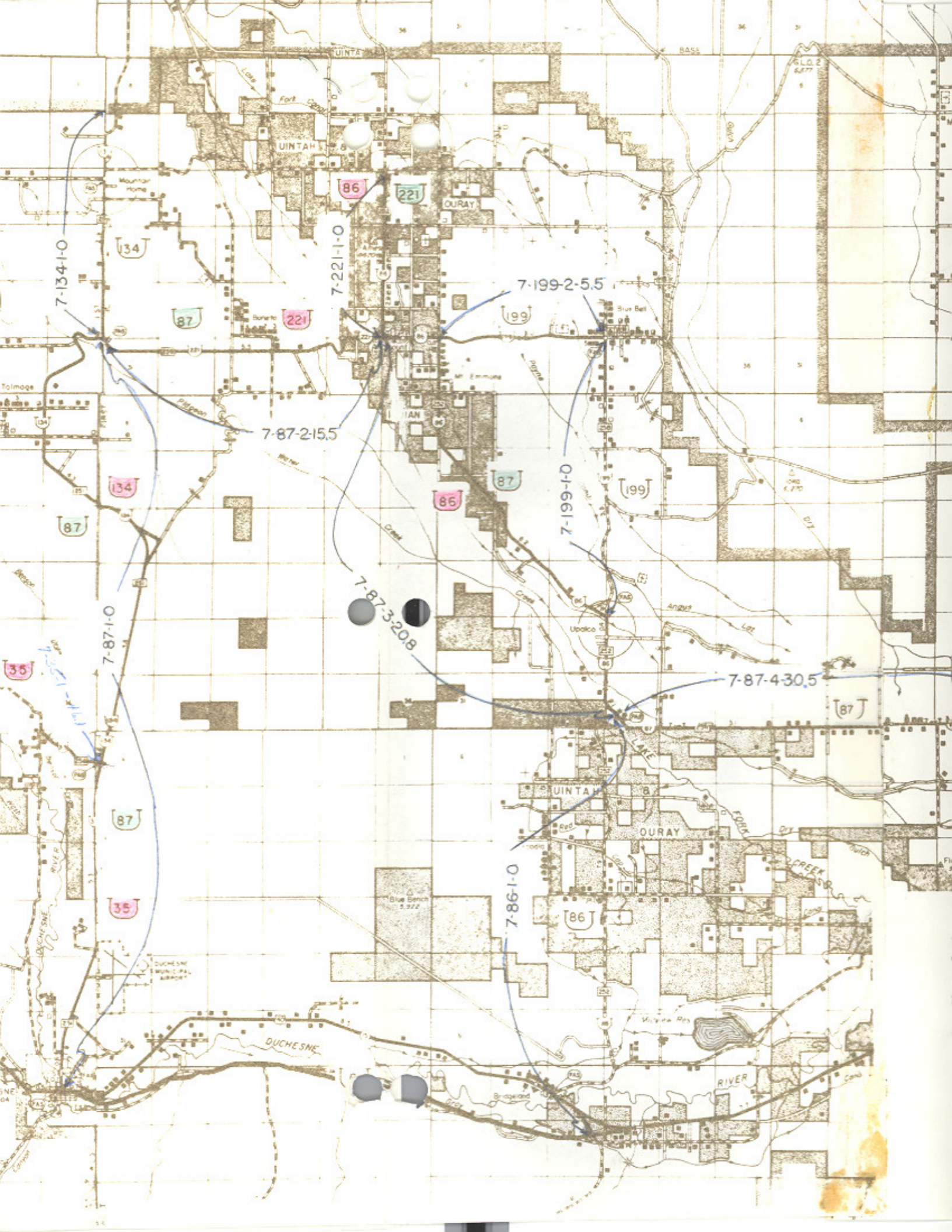

Lawrence [unclear]
Secretary

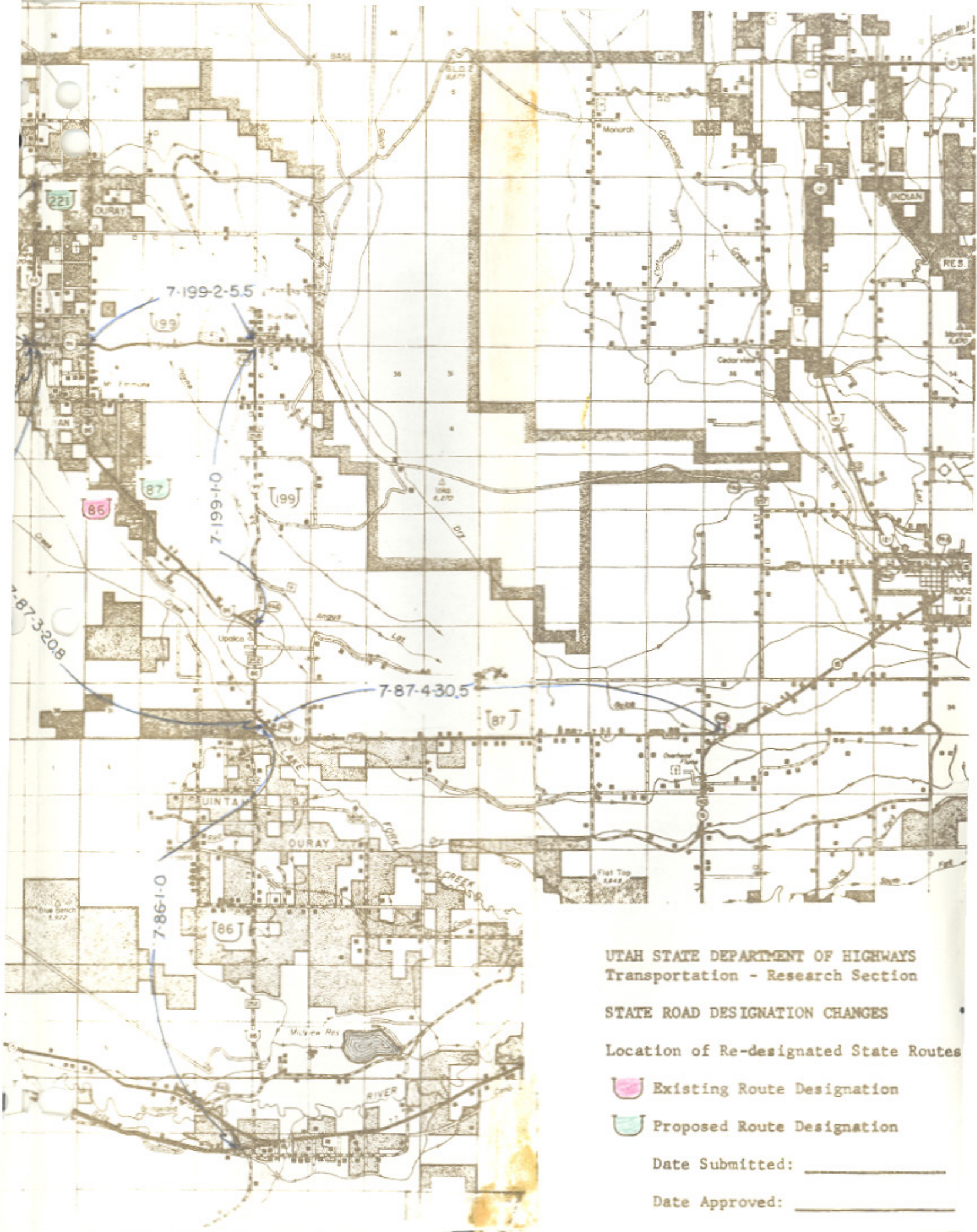



UTAH STATE DEPARTMENT OF HIGHWAYS
 Transportation - Research Section

STATE ROAD DESIGNATION CHANGES
 Location of Re-designated State Routes

-  Existing Route Designation
-  Proposed Route Designation

Date Submitted: _____

Date Approved: _____